

AFL-CIO Library Entrance Feature

Location:

*George Meany Center Campus
10000 New Hampshire Avenue
Silver Spring, Maryland*

Client: *George Meany Memorial Archives, c/o
George Meany Center for Labor Studies, Inc.*

Description:

- *Library Entrance Feature*
- *Library Reception*
- *Librarian's Office*

Contractor: *Tuckman-Barbee Construction
Company, Inc.*

Construction Cost: *\$150,000*

Completion Date: *October 1993*



Chuck Levin's Washington Professional Systems

Location:

11242 Grandview Avenue
Wheaton, Maryland

Client: *Chuck Levin's Washington Music Center*

Description: *Interior architecture for a state of the art sound and recording systems showroom & sales offices*

- 1993 Area of tenant fit-up: 6,265 SF
- 1994 Area of expansion: 3,210 SF

Construction Cost: \$500,000

Completion Date: November 1993

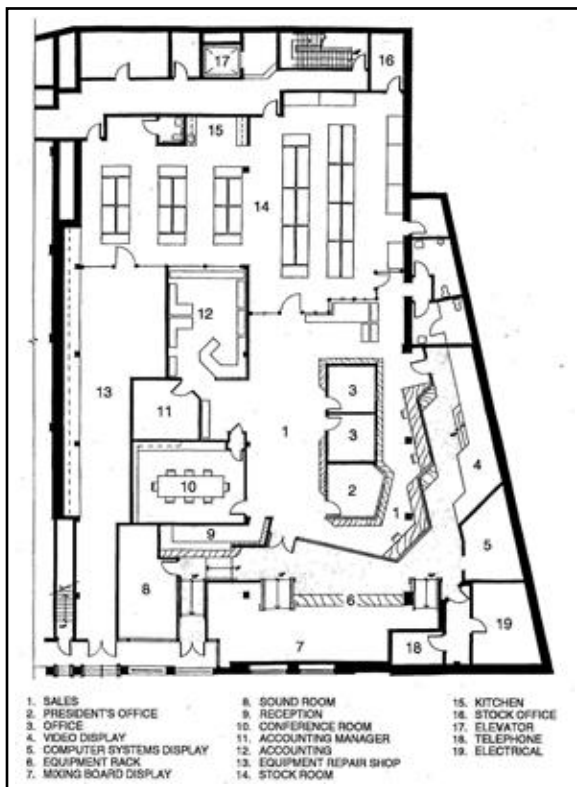
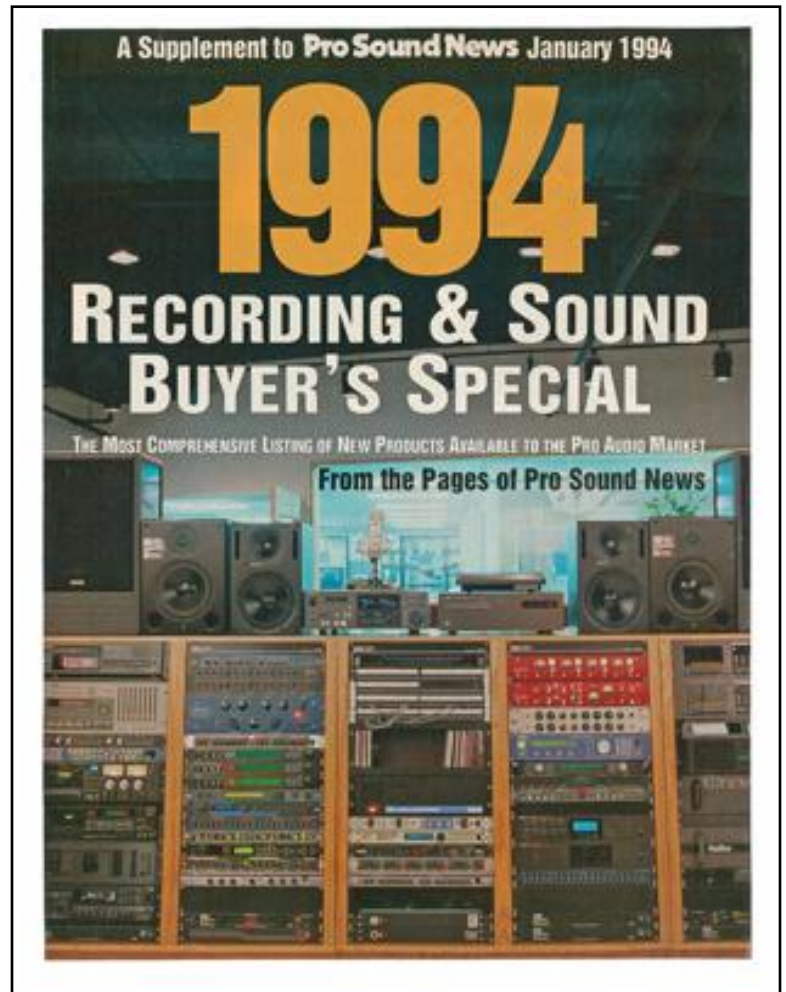



Lydell Road Warehouse & Offices of Georgetown Roofing

Location:

4849 Lydell Road
Cheverly, Maryland

Client: *John Argiropoulos c/o Georgetown Roofing*

Description:

- 2 Stories
- Area: 19,200 GSF

Contractor: *Pioneer Builders*

Construction Cost: \$870,582

Completion Date: *September 1993*



Spartan Liquor & Deli

Location:

11421 Old Baltimore Pike
Beltsville, Maryland

Client: Pete Glekas dba Spartan Liquor & Deli

Description:

- 2 Story load bearing masonry
- Ground floor mercantile sales area: 2,630 gsf
- Second floor office area: 500 gsf

Contractor: Jerome S. Cripps, Construction Manager

Construction Cost: \$500,000

Completion Date: April 1993

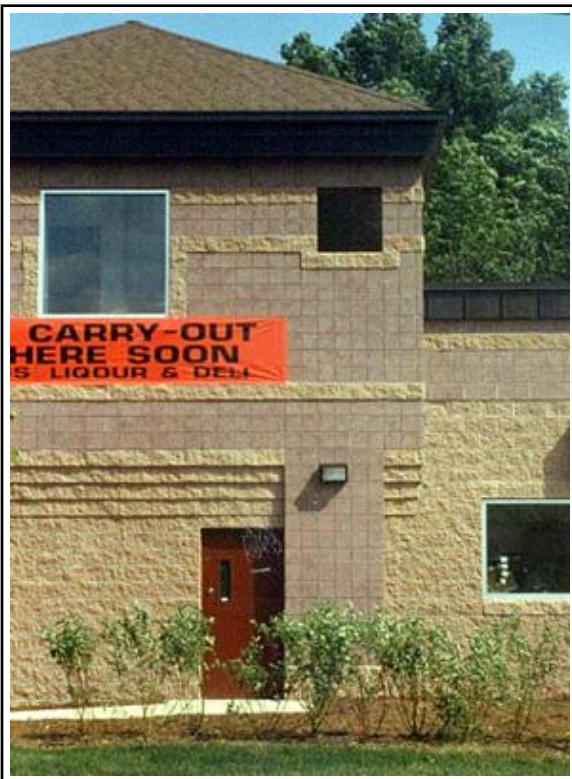
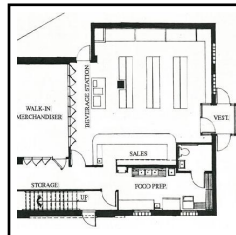



White Flint Station Shopping Center

Location:

11610 - 11640 Rockville Pike
North Bethesda, Maryland

Client: 11610-20 Rockville Pike Partnership, c/o
The Greenberg Company

Description:

- Phase I Facade Renovation
- Phase II Addition: 11,107 GSF

Contractor: Gordon Maizel Construction Co.,
Inc.

Construction Cost: \$1.072 Million

Completion Date: June 1993

